

2.8mm M12-12 1/2. ” TTL:13.9mm

◆Focal Length: 2.8mm

◆Sensing Area: 1/2.7”

◆Resolution:Mega Pixels

◆Mount Type:M12*P0.5-6g

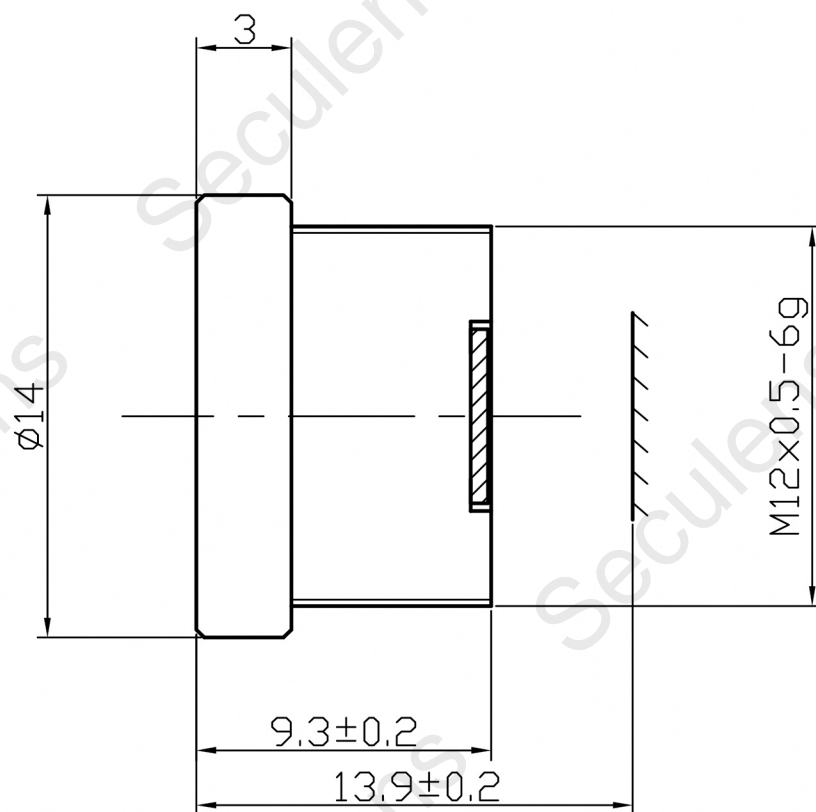

- | | |
|--------------------------------|-----------------------|
| 1. Focal Length: | f: 2.8 mm \pm 5% |
| 2. Sensing Area: | 1/2.7” |
| 3. Angle of View(D): | D=146° |
| Angle of View(H): | H=110° |
| 4. Mount Type: | M12*P0.5-6g |
| 5. Iris Operation: | Fixed |
| 6. Zoom Operation: | Fixed |
| 7. Focus Operation: | Manual |
| 8. Relative Aperture: | 2.4 \pm 5% |
| 9. TTL: | 13.9mm |
| 10. Optical Back Focal Length: | 4.7mm \pm 5% |
| 11. Flange Back Focal Length: | 4.6mm \pm 5% in air |
| 12. Dimension: | $\phi 10$ *L9.3mm |
| 13. Lens Structure: | 4E+IR |
| 14. Distortion: | <-62% |
| 15. M. O. D: | 0.3m ~ ∞ |
| 16. Weight: | 3.5g |
| 17. Operating temperature: | -10 ~ +60° |

Tolerances		Date	2019/7/28
X. +0.2	X. \pm 0.2°	Design	Jonny Li
.X+0.1	.X \pm 0.1°	Check	
.XX \pm 0.05	.XX \pm 0.05°	Approval	Duan Z
			Scale 4:1
			Units mm

